

WALL TYPE LEGEND

Refer to latest specification for detailed technical requirements of wall types

- 100mm Facing Brick External Wall
50mm Clear Void
60mm Kingspan Kooltherm K8 or similar
150mm R.C Wall
To achieve Min U value 0.25 W/m²K
- 215mm R.C Party Wall
Between 2 Heated Spaces
Min Density 2200kg/m³
REFER TO PARTWALL & FLOOR DETAILS
- 215mm R.C Party Wall
25mm Battens
62.5mm Insulated Plasterboard
Kingspan Kooltherm K18 or similar
Between 2 Heated & Heated Spaces
Min Density 2200kg/m³
To Achieve Min U value of 0.32W/m²K
REFER TO PARTWALL & FLOOR DETAILS
- Rain Screen Clad wall
Rain Screen System
90mm Foil Faced Insulation
12mm Sheathing Board
150mm Studs with insulation between
Vapour Control Layer
2 layers 15mm Plasterboard
To achieve Min U value of 0.29W/m²K
- 70mm Metal Stud Partition dry lining to comply
with fire strategy drawings & written specification
- Insulated stud partition to achieve 40db sound resistance
- Stud partition to box SVP & RWP
REFER TO SVP/RWP Detail

Stud walls to be lined with British Gypsum Gyproc Soundbloc, moisture resistant to bathrooms & WC.
All walls to bathrooms & WC to be reinforced between 300mm & 1800mm from FFL to allow for future grab rail fixings Lifetime Home Criteria 11.

BLOCK STRENGTHS TO STRUCTURAL ENGINEERS DESIGN.

Part E

- All partition construction to adhere to the 'British Gypsum White Book' best practice.
- Studwork walls between bathrooms & habitable rooms, bedrooms & habitable rooms are to achieve 40db sound resistance.
- Construction to be typically 12.5mm wallboard or similar plasterboard to both sides filled with 25mm bowed APR 1200 roll or similar.
- With the exception of any relevant walls with a door in it.
- All boards to have a min density of 10kg/m².
- All products specified are 'British Gypsum' all variations to be similarly approved.
- Overlapped boards to be staggered, all joints to be taped and sealed.
- Kitchens to be reinforced to take high level storage units.

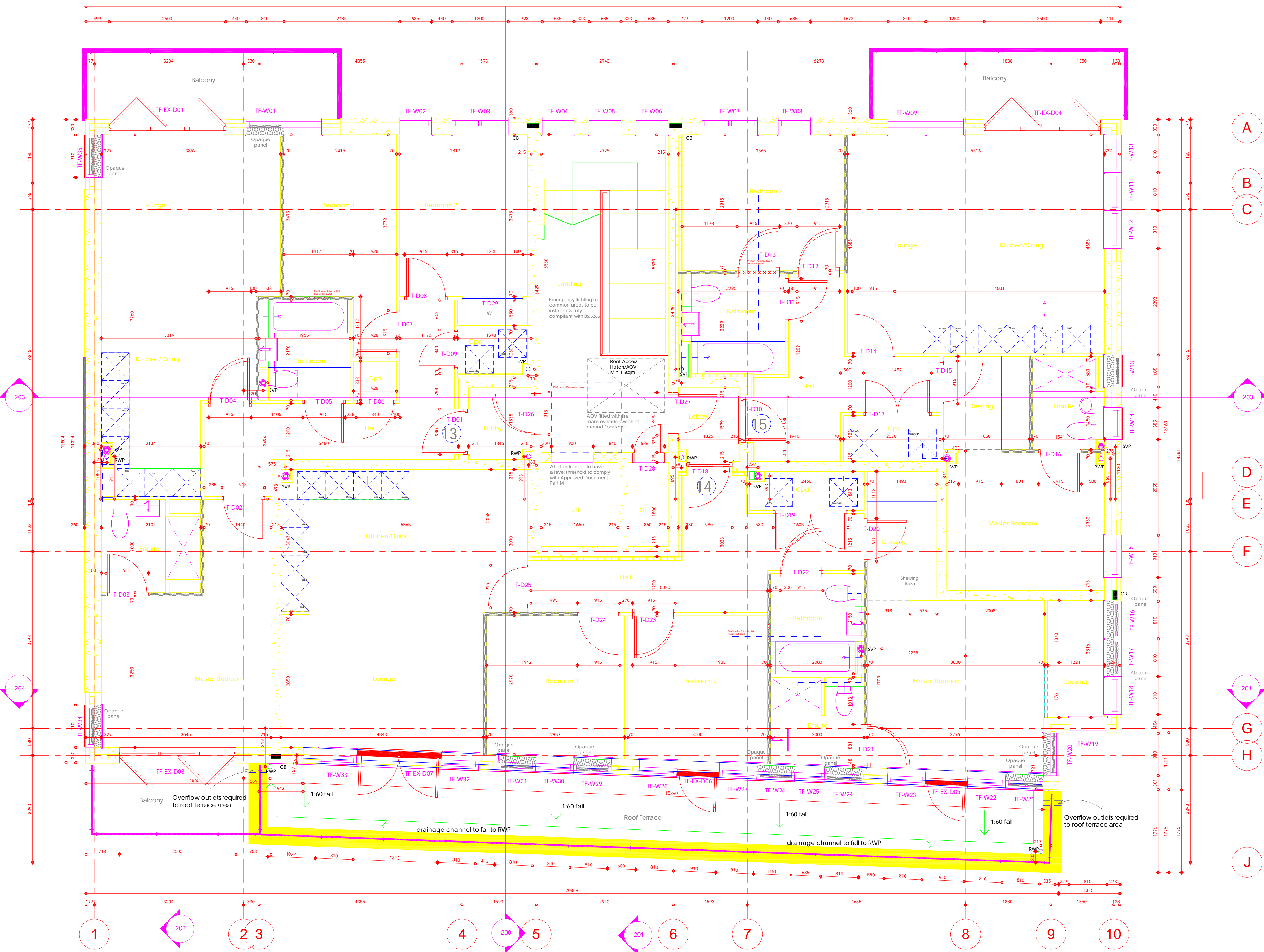

Third Floor Internal Door Schedule								
Mark	Door Panel Width	Structural opening width	Structural opening height	Plot No.	Room	Level	Fire Rating	Comments
T-D01	877	980	2100	Plot 13	Main Entrance Door	19.45 - Third Floor	FD30 with Smoke Seal	To comply with Lifetime Homes criteria 4 & 16, Flat Entrance Door
T-D02	838	915	2040	Plot 13	Master Bedroom	19.45 - Third Floor	FD30	
T-D03	838	915	2040	Plot 13	En Suite	19.45 - Third Floor	FD30	
T-D04	838	915	2040	Plot 13	Kitchen	19.45 - Third Floor	FD30	
T-D05	838	915	2040	Plot 13	Bathroom	19.45 - Third Floor	FD30	
T-D06	762	840	2040	Plot 13	Cpd	19.45 - Third Floor	FD30	
T-D07	838	915	2040	Plot 13	Bedroom 3	19.45 - Third Floor	FD30	
T-D08	838	915	2040	Plot 13	Bedroom 2	19.45 - Third Floor	FD30	
T-D09	762	840	2040	Plot 13	Cpd	19.45 - Third Floor	FD30	
T-D10	877	980	2100	Plot 15	Main Entrance Door	19.45 - Third Floor	FD30 with Smoke Seal	To comply with Lifetime Homes criteria 4 & 16, Flat Entrance Door
T-D11	838	915	2040	Plot 15	Bathroom	19.45 - Third Floor	FD30	
T-D12	838	915	2040	Plot 15	Bedroom 2	19.45 - Third Floor	FD30	
T-D13	838	915	2040	Plot 15	Bathroom	19.45 - Third Floor	FD30	

Third Floor Internal Door Schedule								
Mark	Door Panel Width	Structural opening width	Structural opening height	Plot No.	Room	Level	Fire Rating	Comments
T-D14	838	915	2040	Plot 15	Lounge	19.45 - Third Floor	FD30	
T-D15	838	915	2040	Plot 15	Master Bedroom	19.45 - Third Floor	FD30	
T-D16	838	915	2040	Plot 15	En Suite	19.45 - Third Floor	FD30	
T-D17	688	1452	2040	Plot 15	Cpd	19.45 - Third Floor	FD30	
T-D18	877	980	2100	Plot 14	Main Entrance Door	19.45 - Third Floor	FD30 with Smoke Seal	To comply with Lifetime Homes criteria 4 & 16, Flat Entrance Door
T-D19	762	1605	2040	Plot 14	Cpd	19.45 - Third Floor	FD30	
T-D20	838	915	2040	Plot 14	Master Bedroom	19.45 - Third Floor	FD30	
T-D21	838	915	2040	Plot 14	En Suite	19.45 - Third Floor	FD30	
T-D22	838	915	2040	Plot 14	Bathroom	19.45 - Third Floor	FD30	
T-D23	838	915	2040	Plot 14	Bedroom 2	19.45 - Third Floor	FD30	
T-D24	838	915	2040	Plot 14	Bedroom 3	19.45 - Third Floor	FD30	
T-D25	838	915	2040	Plot 14	Kitchen	19.45 - Third Floor	FD30	
T-D26	838	915	2040	Communal	Lobby	19.45 - Third Floor	FD30 with Smoke Seal	To comply with Lifetime Homes criteria 4 & 16, Vision Panel Required
T-D27	838	915	2040	Communal	Service Riser	19.45 - Third Floor	FD30 with Smoke Seal	Single Door/Access Hatch, Service Riser, Locked, Self Closer, KEEP LOCKED SHUT sign
T-D28	610	688	2040	Communal	Lobby	19.45 - Third Floor	FD60	To comply with Lifetime Homes criteria 4 & 16, Vision Panel Required
T-D29		1300	1981	Plot 13	Wardrobe	19.45 - Third Floor		Wardrobe doors s/s to be agreed by client